

# Mappa, Inc.

1956 Richardson Highway  
North Pole, AK 99705  
(907) 488-1266

## Special Inspection Daily Report

Client: Alcan Builders Project: EIE 430

Test Date: 07/26/25 Test Time: \_\_\_\_\_ Inspector: John Trush

Contact: Bobby Type of Inspection: Reinforcing steel

Time Charged to Project: Start Time 1:30 End Time 4:30 Total Hours Charged RT 3 OT 3

### Inspections performed and locations

Location	Inspection Performed
Fire Pump Room: Spread Footings B.6/1.6, C.4/1.6, D.1/1.6 D.8/1.6, D.8/1.1 Continuous Footing B.8/1.6 Man Hole 2 Hydrant bumpout man Hole 2 Bumpout Hydrant. MH2 Skel Extension	<p>Inspection of reinforcing steel was performed at listed locations. Inspected reinforcing bars were the correct sizes, shapes, type, in clean condition and placed in forms free of debris. Forms were built of approved material and shaped to hold shape.</p> <p>Inspected reinforcing steel appears installed in accordance with approved contract documents for spacing and clearance.</p> <p>Please reference DWG NO. 01 Fire pump room Found. wall elev 01, DWG 00 05 MH-2 Section, DWG 06 MH3 section</p>

### Items requiring correction, correction of previously listed items and/or previously listed uncorrected items

	<u>None</u>

### Changes to approved plans authorized by engineer or architect of record (include paperwork)

	<u>Reference attached RFI-0109 answered 07/07/25</u>
	<u>By Brent Goering, W/S-503 changes to Braced</u>
	<u>Frame Footing, changes to spread Footings.</u>

To the best of my knowledge, work inspected was in accordance with the approved plans and specifications

Signature: \_\_\_\_\_ Printed Name: John R. Trush CET

 US Army Corps of Engineers	<b>Request for Information Report (RFI)</b>		RFI NO. RFI-0109	PAGE NO. Page 1 of 1
	CONTRACT NO. W911KB24C0025 NA J4001808	CONTRACT TITLE EIE430, Fire Suppression Corrosion Ctrl		PRIME CONTRACTOR ALCAN BUILDERS INC.

**Contractor's Request for Information**

REQUESTED BY Craig Sandine	DATE REQUESTED June 28, 2025	POTENTIAL COST IMPACT No	POTENTIAL SCHEDULE IMPACT No
RFI SUBJECT	Braced Frame Footing-Pedestal Clarification		
SPECIFICATION SECTIONS	03 30 00		
DRAWINGS	S-101 & S-503		
SUBCONTRACTOR			

**Information Requested**

Drawing S-101 show tops of footers at Grid Lines 1.6 and D.8 are shown to be -2.0' to match existing strip footers. With the finished floor of the Fire Pump Room being -1' 3 1/4", Detail A1 on S-503 doesn't accurately represent the conditions at the Fire Pump Room footers. Given elevations, the pedestal would be 3 3/4" tall. The anchor bolts are 9" long, so following Det A1, the bolts would transition a cold joint at the short pedestal.

We recommend increasing the thickness of the footer to 15 3/4" thick so the anchor bolts are fully set in a single pour. This would apply to 4 column locations.

**Contractor Recommendation**

Thicken the footer at 4 column locations depicted in attached.

**Contractor Attachments**

Document Package: June 28, 2025  
RFI-0109 Braced Frame Footer-Pedestal Clarification.pdf

**Government Response**

ANSWERED BY Brent Goering	DATE RECEIVED June 30, 2025	DATE ANSWERED July 07, 2025
TITLE Mechanical Engineer		

**Government Response to Contractor**

The proposed thickening of the footing in the indicated locations is acceptable.

This information is provided as a clarification under FAR 52.236-21, Specifications and Drawings for Construction, rather than as a change under FAR 52.243-4, Changes. It shall not result in an increase in contract price or duration. If you do not agree, please provide written notice including information to establish and support your position in accordance with FAR 52.243-4, and do not proceed with this work without further direction from the Government.

**Government Attachments**

--	--	--

NOTE: THE RFI SYSTEM IS INTENDED TO PROVIDE AN EFFICIENT MECHANISM FOR RESPONDING TO CONTRACTOR'S REQUESTS FOR INFORMATION. IT DOES NOT PROVIDE AUTHORITY TO PROCEED WITH ADDITIONAL WORK. IF THE CONTRACTOR CONSIDERS THE RFI RESPONSE A CHANGED CONDITION, PROVIDE WRITTEN NOTICE TO THE CONTRACTING OFFICER'S REPRESENTATIVE IN ACCORDANCE WITH CONTRACT PROVISIONS.	QA REVIEWER'S SIGNATURE Digitally signed by GAVIN.MICHAEL.DAVID.1555543316 Date: 2025.07.07 12:05:14 -08:00 Title: Project Engineer, COR	DATE
---	--	------

 <b>US Army Corps of Engineers</b>	<b>Request for Information Report (RFI)</b>		RFI NO. RFI-0109	PAGE NO. Page 1 of 1
	CONTRACT NO. <b>W911KB24C0025 NA J4001808</b>	CONTRACT TITLE <b>EIE430, Fire Suppression Corrosion Ctrl</b>	PRIME CONTRACTOR <b>ALCAN BUILDERS INC.</b>	

**Contractor's Request for Information**

REQUESTED BY Craig Sandine	DATE REQUESTED June 28, 2025	POTENTIAL COST IMPACT No	POTENTIAL SCHEDULE IMPACT No
RFI SUBJECT	Braced Frame Footing-Pedestal Clarification		
SPECIFICATION SECTIONS	03 30 00		
DRAWINGS	S-101 & S-503		
SUBCONTRACTOR			

**Information Requested**

Drawing S-101 show tops of footers at Grid Lines 1.6 and D.8 are shown to be -2.0' to match existing strip footers. With the finished floor of the Fire Pump Room being -1' 3 1/4", Detail A1 on S-503 doesn't accurately represent the conditions at the Fire Pump Room footers. Given elevations, the pedestal would be 3 3/4" tall. The anchor bolts are 9" long, so following Det A1, the bolts would transition a cold joint at the short pedestal.

We recommend increasing the thickness of the footer to 15 3/4" thick so the anchor bolts are fully set in a single pour. This would apply to 4 column locations.

**Contractor Recommendation**

Thicken the footer at 4 column locations depicted in attached.

**Contractor Attachments**

--

**Government Response**

ANSWERED BY No Answer	DATE RECEIVED	DATE ANSWERED
TITLE		

**Government Response to Contractor**

COR/ACO has not approved this government response.

**Government Attachments**

--

NOTE: THE RFI SYSTEM IS INTENDED TO PROVIDE AN EFFICIENT MECHANISM FOR RESPONDING TO CONTRACTOR'S REQUESTS FOR INFORMATION. IT DOES NOT PROVIDE AUTHORITY TO PROCEED WITH ADDITIONAL WORK. IF THE CONTRACTOR CONSIDERS THE RFI RESPONSE A CHANGED CONDITION, PROVIDE WRITTEN NOTICE TO THE CONTRACTING OFFICER'S REPRESENTATIVE IN ACCORDANCE WITH CONTRACT PROVISIONS.	QA REVIEWER'S SIGNATURE	DATE

A B C D E F G H

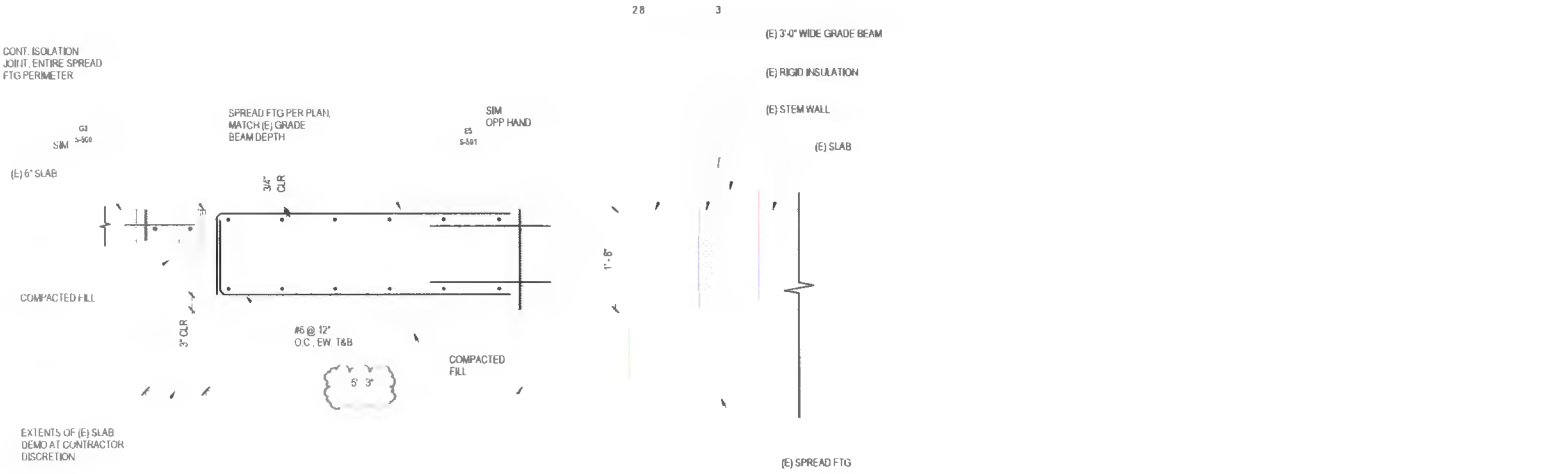

**A5 POUR BACK FOOTING DETAIL**  
1" = 1'-0"

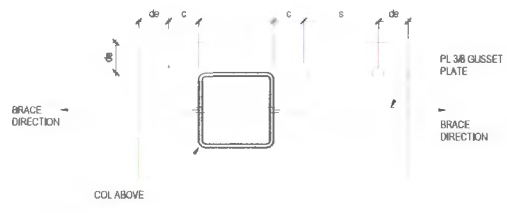
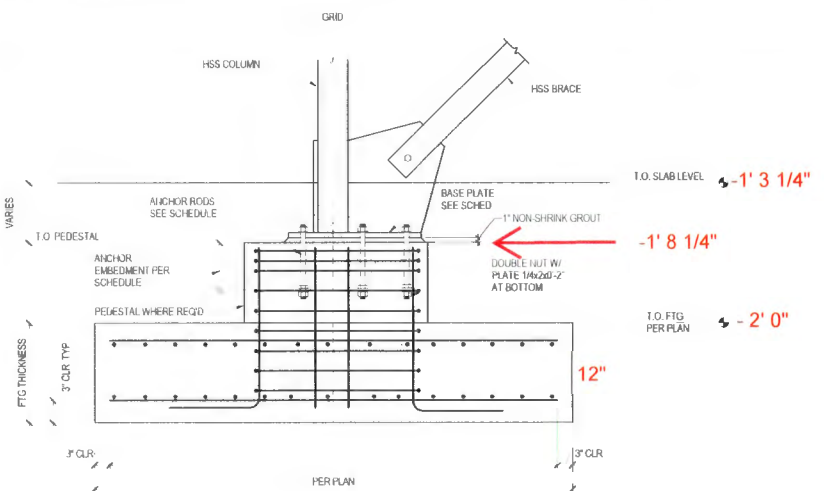

BASE PLATE & ANCHOR ROD SCHEDULE FOR BRACED FRAMES							
COLUMN TYPE	BASE PLATE THICKNESS	db	c	s	ANCHOR ROD SIZE	PL WASHER SIZE	REMARKS
HSS	3/4"	2	2	5	3/4" x 9" MIN EMBED A 1504 GR 55	PL 1/4 x 2 x 0'-2"	SEE TABLE ON B3510

**A1 BRACED FRAME FOOTING**  
1" = 1'-0"

**E1 BRACED HSS COLUMN BASE PLATE**  
3" = 1'-0"



CONTRACT NO. W911KB24C0025  
CONTRACTOR: [Blank]  
DATE: [Blank]

[Blank grid area]

CONTRACT NO. W911KB24C0025  
DATE: FEB 7, 2024  
PROJECT: [Blank]  
DRAWING: [Blank]

ENGINEER: [Signature]  
E1E30  
US ARMY ENGINEER DISTRICT  
ALASKA DISTRICT  
CORPORAL  
DETAILS  
FOUNDATION AND SLAB DETAILS



**AWARD**

Reference number  
**S-503**